



The Marksmen

The Annual General Meeting Is coming

AGM

The Annual General Meeting is scheduled for **Tuesday, May 31st**. It will begin at **7:00 PM**. All current members are welcome and encouraged to attend. Reports will be given from the sections; elections of directors, motions will be tabled for the usual housekeeping affiliations. As usual, snacks will be served after the meeting. In an effort to have more members participate in the AGM. **If you cannot attend; we encourage you to fill out and send in the proxy form for the major motions being tabled at the meeting with the enclosed envelope.**

General Shooting moves back outside on May 7th

As of May 7th, Saturday General Shooting will be held at the Outdoor Range for Saturdays only. Shooting will continue there for Saturdays (Tuesday nights will remain indoor) until October 1st.

Guests Don't forget AMA's guest policies – it's attached to this newsletter.

Are you on our AMA email notification list?

Occasionally we send out reminders of scheduling, issues, notifications, etc. send an email to atlanticmarksmen@gmail.com to be added to the list.

Range Rules are posted at the ranges so you cannot miss them. They are also included with this newsletter, as they have been for the past 40 issues of the newsletter. Ignorance of the rules is not considered an excuse to violate them. These rules are for your safety and the safety of others. If you ignore these rules, not only do you jeopardize having the range closed, you jeopardize yours or someone else's life.

Card Keys at the Indoor Range. If you have issues with your key cards, please email Sean Hansen and include the card key # in your note.

Range Officer Schedule – The new range officer schedule is attached to this newsletter. It will also be posted in the indoor range. If you are on this list, you are required to range officer when you are scheduled. If you cannot make it, contact one of the other ROs and trade. It is your responsibility to find the list and make sure you do your duty. The penalty for not doing your duty is that you have to return your keys.

Explosive Targets are prohibited at AMA's Indoor & Outdoor Range. They are permitted under special circumstances at the outdoor range.

"Shockwave" or "Tannerite" or "Firebird" targets are prohibited on any of AMA's ranges.

AMA Practice Nights - IPSC shooters. AMA IPSC practice sessions will move to Thursday nights outdoors as of April 27th. This will be for the entire summer. If it is pouring rain, don't expect the gate to be open, but if it's just misting, we'll be there with the gate open. The indoor range will still be available to IPSC Shooters on Wednesday nights & Sunday afternoons as well.

Outdoor Range Ranges 5-7 remain off limits to anyone that is not currently participating in a recognized action shooting discipline. Exceptions are available from the Executive in writing.

RO Hours: The times presented for shooting on Tuesdays and Saturdays are when the RO is on duty, if shooters are present. If the RO has no shooters within one hour of closing time; he may shut down and go home.

Ranges are not parking lots - PARKING is only permitted at the outdoor range in the parking lots, with a couple of small exceptions. (See Standing Orders) Vehicles parked elsewhere will be pelted with ricochets, mud, rocks and probably towed downrange to be used as targets.

IPSC Black Badge course – there will be one on the weekend of June 25/26 – email ipscnovascotia@gmail.com for information and to enroll.

The Marksmen

How to use a Target Stand for the Outdoor facility.

The proper way to use a stand is to take a piece of cardboard and staple it across both uprights on the stand. Then attach a target to the cardboard. Do not attach a target so that your shots will penetrate the target and the upright of the target stand. You should always be able to find discarded IPSC and police targets in one of the trailers to use as backers.

Parking at Outdoor range - When you park; **do not block any other vehicle and do not block the access roads** to the rifle range or the back pistol ranges. If there is no parking remaining close to the rifle range, you'll have to park in the pistol range parking lot and walk. Please be considerate to your fellow range users so we don't have to deal with this this summer.

Outdoor Range Schedule.

IPSC - May 15, June 5, June 19, August 21, Sept 11,

IPSC Canada Handgun Championship – July 25 – August 1 Ranges 1-8 in Use. (General Shooting Indoors August 30)

IPSC Nova Scotia Provincial Championships – Oct 1 & 2
Ranges 1-7 in Use. (General Shooting Indoors Oct 1)

Project Mapleseed Friday, September 16-18th. Rifle Range and Range 1 in use.

Indoor range – June 25/26 Black Badge (Both ranges in use)

This schedule may change – we will email out if any changes are necessary.

Ticks at the outdoor range. Like every year, there will again be ticks at the outdoor range. Make sure that you use insect repellent with lots of DEET in it and check yourself thoroughly when you return from the range to ensure none have hitched a ride on you.

Please Help Us Clean Up - Just a reminder that when you use the facilities, please throw your discarded brass, old targets, **coffee cups**, patch backers, etc. in the garbage cans and not on the range surface. When you use the indoor range, sweep up after yourself and when you're outdoors remember to **take down your old target**. It's no use to anyone after the rain gets on it the next day.

Woods Travel Ban: If we have a dry summer, the province might institute a woods travel ban. The outdoor range is exempt from this and remains open during the ban. Just be sure to be careful when it comes to any fires, i.e. smoking, etc.

Atlantic Marksmen Association

Contact Us

The editor, publisher, folder, packer and mailer of this newsletter is the president of the club; Sean Hansen. Sean can be reached at work at 455-5483 or via email at atlanticmarksmen@gmail.com
Our mailing address is AMA, PO Box 181 Dartmouth Main, Dartmouth, NS B2Y 3Y3

Don't forget our Website www.atlanticmarksmen.ca

Don't forget at the Outdoor Range:

- **Failure to sign in at the facility before you fire your first shot will result in you being sent off the property for the day.**
- **Through May, please drive slowly and don't cause pot holes.**
- **GARBAGE: Take care of it yourself!!!** At the outdoor range, there is a dumpster in the parking lot. If you fill a garbage can, take the bag and put next to the dumpster and we'll put it in
- **Have your current membership card with you.** No card = no proof of membership and ejection from the facilities.
- **Park properly!** Don't block others in and keep your vehicles in safe locations.
- **Steel Shooting at the Outdoor Range** Steel plates or poppers shot on Ranges 2&3 cause splatter to land on ranges 5&6. Therefore steel on range 2,3&4 must be shielded. Steel shot on Range 1 causes splatter to land on range 2 & 4, so unless the steel is at the end of the range - it, too must be shielded.

DO NOT shoot steel that does not belong to you.

Section Chairs & Executive

Sean Hansen – Pres. 455-5483
sales@freedomventures.ca

James Smith – Vice Pres. Jim@division8.co

Graham Fortune – Treasurer 497-1143
gbfort@bellaliant.net

Anees Obeid – Secretary 830-6969 anees@eastlink.ca

Brad Browne – Section Chair; Long Arms
221-5646 coffee@ns.sympatico.ca

Andrew Brace – Section Chair; Handgun
435-7510 andrewbrace6@hotmail.com

**AMA Shooting Schedule
May 1, 2022 to Oct 15, 2022**

Monday Evenings	Air Pistol and Rifle Indoors. Begin at 5:00 PM
Tuesday Evenings	General Handgun. All members are welcome. Begin at 6:30 PM at the Indoor Range.
Wednesday Evenings	IPSC Shooting. Black Badge Holders, beginning at 5:30 PM – Indoor and Outdoor Range.
Thursday Evenings	ISU / ISSF Style Shooting in the indoor range. Begin at 6:30.
Saturday Afternoon	General shooting. All members are welcome. Range 1. Begin at 1:00 PM <u>at the outdoor range.</u> <i>NOTE: RO may pack up and leave if no one is left shooting at 3.</i>
Sunday Morning	Shotgun Shooting. All members welcome (bring your own clays) Held from the shotgun shelter in the outdoor range. Begin at 1:00 PM.
	Rifle Shooting on Outdoor Rifle Range. Begins at 10, ends at noon.

AMA AGM 2022 Fact Sheet

In an attempt to get more of our general membership to participate in the Annual General Meeting, we're sending out proxy forms to all our members for the usual major motions.

The following motions will be tabled at the AGM. A proxy form is attached to this newsletter for you to cast your vote. This is the associated information for those motions.

As of printing time, the individual reports were not available; therefore, no proxy vote will be available for them.

The Proxy Form will be regarding the following Motions.

1. Elections. All the existing board members have re-offered for their existing positions. The Nominating Committee will present the following slate:
 - 1.1 Election of President. Sean Hansen, incumbent is re-offering.
 - 1.2 Election of Vice President, James Smith is offering.
 - 1.3 Election of Secretary; Anees Obeid, incumbent is re-offering.
 - 1.4 Election of Treasurer; Graham Fortune, incumbent is re-offering.
- 1.5 Election of Handgun Section; Andrew Brace, Marcel Boudreau, Ronald Hilchey, Michael Lee, Wade MacKay. All re-offering.
- 1.6 Election of Rifle Section. Don Ferris, Brad Browne, Tony Tufts. Shawn MacPhail and Scott Vigneault.
- 1.7 Election of Members at Large; Andrew Dobson, Steven Parker, Peter Dimmell and Mike Wood. All re-offering.
2. These Housekeeping Motions will be presented. We have always approved these motions.
 - 3.1 Motion for AMA to Associate with the Shooting Federation of Nova Scotia.
 - 3.2 Motion for AMA to Associate with the Shooting Federation of Canada.

Standing Orders for Indoor Range

General Information

If you do not have your current membership card with you while on AMA premises, you may be asked to leave.

- Refer to AMA Guest Rules for information regarding guests at AMA premises.
- **One person on the range proper MUST be a certified Range Officer.**
- Range Hours are 8:30 AM to 9:30 PM. No shooting outside of those times unless prior approval from the board has been granted.
- The following is prohibited: Steel reactionary targets unless shrouded. (I.e. plates, silhouettes, etc.), Black Powder firearms. Steel core or jacketed ammunition, Incendiary or Explosive Targets, Rifle Caliber Centerfire rifles / carbines, **Pistol Caliber Carbines (i.e. 9mm, 38 Special, 40S&W, 45ACP, 44 Mag, 357 Mag) are specifically permitted.**
- Magnum pistol calibers are permitted with the permission of the Range Officer and Chief Range Officer. Please consider others on the range with regard to concussion and noise.
- Jacketed ammunition is permitted and encouraged (less smoke)
- No shooting within 3 meters of the backstop.
- No Eating, Drinking or Smoking on the ranges.
- Sweep the range floor with dust bane and throw it in the garbage when you are done shooting.

Before any Shooting

- All guests must be signed into the logbook. Both their host member and Guest must have their names legible.
- Inform the Range Officer you will be shooting before doing anything else. He will instruct you as to when and where you can un-box your firearm and shoot.

During Shooting

- Eye and Ear protection are mandatory for all shooters and spectators from the minute they walk into the range until they leave
- No Range may be used without a Range Officer present.

Standard (General Shooting) Range Commands:

Eyes and Ears!

- Ensure you are using your hearing and eye protection.

Approach The Line.

- Move forward and un-box your firearm and /or handle it to prepare for shooting.

On your own Time, Fire.

- Shoot at your target, reload and continue if you have to.

Cease Fire!

- Stop Shooting, unload your gun, leave it open on the table and step back from the firing line.

The Line is Clear.

- Go around the tables and approach your targets. Do not approach the tables from behind the firing line again until told to do so.

After Shooting

- Take down your targets and cardboard backers and put them away. Tear up worn-out backers and put them in the garbage.
- Pick up your spent cartridges. This includes rim fire. If you don't want them, dispose of them in the brass bins.
- Turn off the ventilation, turn out the lights and lock the door (both locks) behind you.

Emergencies

In the Event of an Emergency, call 911. The range Address is 6 Clements St. Dartmouth.

- **Violation of these standing orders will incur a review of the member's actions by the board and could result in suspension of privileges and / or expulsion from the club.**

Atlantic Marksmen Association - Standing Orders for the Ralph Dunn Range

General Information

- If you do not have your current membership card with you while on AMA premises, you will be asked to leave.
- Guests are entitled to shoot with a member; but must join after the second visit to continue using the club facilities. **No more than 3 guests per member** are permitted on the property.
- **One person in each range bay MUST be a certified Range Officer.**
- Range Hours are 10:00 AM to Dusk. No shooting outside of those times unless prior approval from the board has been granted.
- Smoking is only permitted in the parking lot areas. This includes vaping and inhalers.
- The Chief Range Officer (CRO) is the range officer who first opened the gate to the facility. He must designate a new CRO (who must be a range officer) when he leaves or he will have to evict everyone and lock the gate. Anyone who arrives after the CRO who wants to open a new range bay must let the CRO know he is going to do so.
- Parking is to the left and right of the range rules sign. Only vehicles authorized by the CRO & those vehicles with handicapped passes may proceed to the range surfaces.
- Steel may only be shot by pistol calibers and never on ranges 1, 2 or 3 unless shrouded.
- Explosive targets (tannerite, shockwave, etc.) may only be used with written permission of the club president. **Firebird explosive targets may NOT be used**
- Balloons as targets are prohibited.
- Center fire rifle ammunition is prohibited from shooting steel unless the steel is personally owned or the rifle range flash targets are used.

Before any Shooting

- All members and guests must sign in the logbook in the sign-in shack.
- Red Flags must be raised at the entrance gate, at the sign in shack and at each range bay that is in use.

During Shooting

- Eye protection is mandatory for all shooters and spectators on active ranges. Eye protection must be worn when a red flag is raised on a range bay.

Standard (General Shooting) Range Commands:

Eyes and Ears!	- Ensure you are using your hearing and eye protection.
Approach The Line.	- Move forward and un-box your firearm and /or handle it to prepare for shooting.
On your own Time, Fire.	- Shoot at your target, reload and continue if you have to.
Cease Fire!	- Stop Shooting, unload your gun, leave it open on the table and step back from the firing line.
The Line is Clear.	- Go around the tables and approach your targets. Do not approach the tables from behind the firing line again until told to do so.

Range Specific Rules

Rifle Range

- All shooting will be from under the covered firing point unless a board-approved action shooting event is taking place.
- All targets will be placed in front of a berm such that the bullet will travel through the target at strike the berm. There are berms at 100yds, 190yds and 280 yds.
- Shooters must check to ensure that the shotgun range is not in use when proceeding downrange to check targets. It is best to go behind the shotgun shack when proceeding downrange.

Shotgun Range

- Shotgun shooting from the shotgun shelter with the throwers will only take place under the supervision of a designated "Shotgun" Range Officer.
- No bigger than 7.5 shot size may be used at range 8 (the shotgun shelter with skeet throwers)
- Shotguns will be stored in racks, unloaded, except when actually in use on firing point and will not be loaded until the shooter is given the command to load.
- Shooters are limited to 10 rounds per turn and must provide own clays.
- Shooters will not advance forward past the firing positions (into the line of fire from the rifle range)

After Shooting

- Take down your targets and cardboard backers and put them away. Tear up worn-out backers and put them in the garbage.
- Pick up your spent cartridges. This includes rim fire, steel cases and shotgun hulls. If you don't want them, dispose of them in the brass bins or garbage.
- Sign out in the logbook.

Emergencies

In the Event of an Emergency, call 911. The Range Address is 2965 Old Guysborough Rd.

Violation of these standing orders will incur a review of the member's actions by the board and will likely result in suspension of privileges and / or expulsion from the club.

RO Schedule May 7 – October 8, 2022

Saturdays Move Outdoors for Summer	
Sat., May 7	Fred Walsh
Tues, May 10	Dwayne Murphy
Sat., May 14	Chris Turner
Tues, May 17	Graham Fortune
Sat., May 21	Lot Cossar
Tues, May 24	Malcom MacDonald
Sat., May 28	Don Banton
Tues, May 31	No RO – AGM
Sat., June 4	Mark Bamford
Tues, June 7	James Stephens
Sat., June 11	Tim Furey
Tues, June 14	John Francis Rooney
Sat., June 18	Wayne Gillis
Tues, June 21	Gary Leights
Sat., June 25	Simon Field
Tues, June 28	Scott Vigneault
Sat., July 2	Peter Henderson
Tues, July 5	Heather Taylor
Sat., July 9	John West
Tues, July 12	William Pratt
Sat., July 16	Fred Walsh
Tues, July 19	Don Roth

Sat., July 23	Graham Curren
Tues, July 26	Alex Bergman
Sat., July 30	Gary Treadwell
Tues, Aug 2	Ernie Riggs
Sat., Aug 6	John Parkin
Tues, Aug 9	Peter Dimmell
Sat., Aug 13	Dwayne Murphy
Tues, Aug 16	Todd Harnish
Sat., Aug 20	Bill Macrocki
Tues, Aug 23	John Francis Rooney
Sat., Aug 27	Chris Gidney
Tues, Aug 30	Allan Catindig
Sat., Sept 3	Denis Fortin
Tues, Sept 6	Evangeline Colman-Sadd
Sat., Sept 10	Fred Walsh
Tues, Sept 13	David Bardsley
Sat., Sept 17	James Stephens
Tues, Sept 20	Douglas Reid
Sat., Sept 24	Tony Tufts
Tues, Sept 27	Gary Leights
Saturdays Move Indoors for Winter	
Sat. Oct 1	William Pratt
Tues, Oct 4	Chris Turner
Sat., Oct 8	Lot Cossar

**YOU ARE RESPONSIBLE TO OPEN THE RANGE
AT THESE DESIGNATED DATES
IF YOU CANNOT OPEN THE RANGE, IT IS YOUR
RESPONSIBLY TO ENSURE YOUR
REPLACEMENT DOES.**

OUTDOOR RANGE PARKING GUIDE & RANGE #s

*Atlantic Marksmen Association
Ralph Dunn Range*

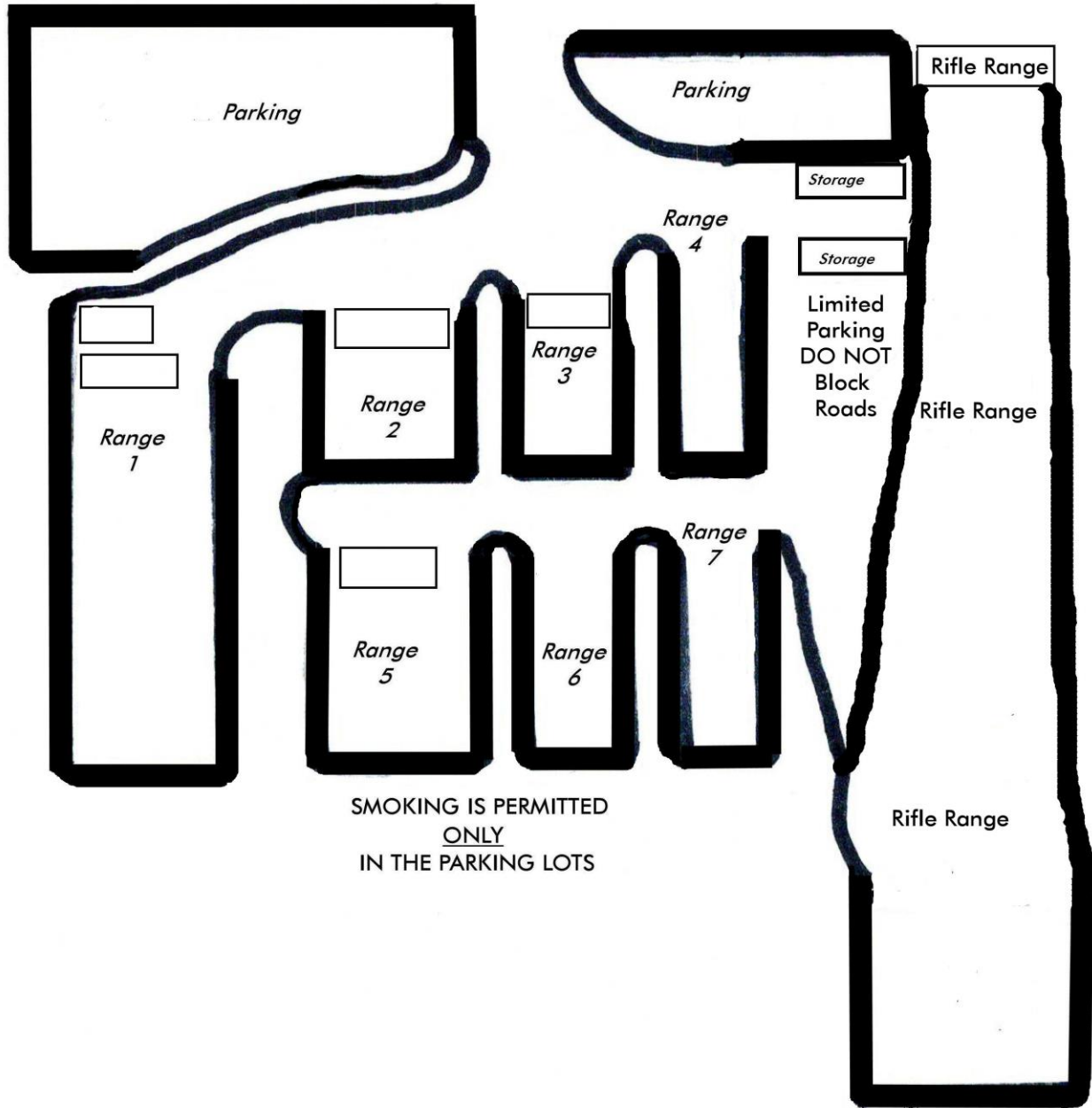

**IF IT DOESN'T SAY YOU CAN PARK THERE,
DON'T PARK THERE!!!!**

We won't be responsible to the damage that will occur to improperly parked vehicles.

Atlantic Marksmen Association 2022 Proxy

This proxy will be used to represent the member _____ for the Annual General Meeting of the Atlantic Marksmen Association to be held on May 31, 2022 at the Atlantic Marksmen Association club house, 6 Clements St. Dartmouth, NS.

Place a large check mark () in the box of your choice

(The small "x" indicates the AMA Executive recommendation, no check mark indicates member agrees with Executive Recommendation.)

Motion	Yes	No	Abstain
1.1 Vote for Sean Hansen for President	x		
1.2 Vote for James Smith for Vice President	x		
1.3 Vote for Anees Obeid for Secretary	x		
1.4 Vote for Graham Fortune for Treasurer	x		
1.5 Vote for Andrew Brace, Marcel Boudreau, Ronald Hilchey, Michael Lee, & Wade MacKay for Handgun Committee	x		
1.6 Vote for Don Ferris, Brad Browne, Tony Tuffts. Shawn MacPhail and Scott Vigneault for Rifle Committee	x		
1.7 Vote for Andrew Dobson, Mike Wood, Peter Dimmell and Steven Parker for Members at Large	x		
2.1 AMA Associate with SFNS for 2022-2023	x		
2.2 AMA Associate with SFC for 2022-2023	x		

I hereby appoint AMA secretary, Mr. Anees Obeid to register my proxy as above at this Annual General Meeting.

Signature

Please Check () the above boxes and mail with included Self-Addressed Stamped Envelope.

**AMA Guest Rules – Applies to Indoor and Outdoor Ranges
Effective January 7, 2016**

- Members are completely responsible for the actions and conduct of their guests.
- Members are permitted to have a total of **Four** guest visits per membership year. *(I.e. 2 people twice each, 1 person twice and 2 more people once each, 4 separate people once each, etc.)* Additional visit credits may be requested from the Executive and will be issued in special circumstances.
- If a member's guest joins the club, their visits will be removed from the member's guest visit count.
- A guest may attend up to **two** times; but must join before being permitted to return the third time.
- **Guests may not bring personal firearms.** Guests may only shoot member's firearms.
- No more than **Three** guests may accompany a member to the range, with the exception of General Shoots on Tuesdays and Saturdays. At General Shoots; members may only bring one guest with them.
- **When guests are shooting, their host member may not.**
- At General Shoots; Members must share their shooting position on the line with their guest.
- When members bring spectators who do not shoot, these spectators are not considered guests. *(I.e. if a Range Officer brings their spouse to be the second person on the range.)*
- Attendance at official competitions & training sanctioned by AMA's executive & included on the AMA Calendar are not considered guest attendance.