



# The Marksmen

## The Annual General Meeting Is coming

### AGM

The Annual General Meeting is scheduled for **TUESDAY, May 26th**. It will begin at **7:00 PM**. The meeting will be held virtually, via the Zoom Application available for smartphones, tablets, laptops and desktop computers.

### Here's where you can get Zoom:

For PCs: <https://zoom.us/> (It's free)

For Apple products: Find Zoom in the App store. (It's free)

For Android products: Find Zoom in the Google Play store. (It's free)

Instructions to connect will be emailed out a week prior.

**General Shooting will move back outside on Saturdays once the Covid thing ends.** Saturday General Shooting will be held at the Outdoor Range for Saturdays only. Shooting will continue there for Saturdays (Tuesday nights will remain indoor) until October 3<sup>rd</sup>

**Guests** Don't forget AMA's guest policies – it's attached to this newsletter.

### Are you on our AMA email notification list?

We no longer mail out newsletters in December or April. Only in September. If you're not on the list, you won't find anything out. Send an email to [atlanticmarksmen@gmail.com](mailto:atlanticmarksmen@gmail.com) to be added to the list.

**Range Rules** are posted at the ranges so you cannot miss them. They are also included with this newsletter, as they have been for the past 36 issues of the newsletter. Ignorance of the rules is not considered an excuse to violate them. These rules are for your safety and the safety of others. If you ignore these rules, not only do you jeopardize having the range closed, you jeopardize yours or someone else's life.

**Card Keys at the Indoor Range.** If you have issues with your key cards, please email Sean Hansen and include the card key # in your note. Make sure you've tried the key card on the old readers (by the door) and on the new readers on the door handle.

**RO Course** – Graham Fortune will put on an RO course in the summer (once we can use the range again) if there is enough interest – contact Graham to register if you are interested. His contact info is listed later in this newsletter. Note that you must have one year's membership to be eligible for this course.

**Range Officer Schedule** – The new range officer schedule is attached to this newsletter. It will also be posted in the indoor range. If you are on this list, you are required to range officer when you are scheduled. If you cannot make it, contact one of the other ROs and trade. It is your responsibility to find the list and make sure you do your duty. The penalty for not doing your duty is that you have to return your keys.

**Explosive Targets are prohibited at AMA's Indoor Range. They are permitted under special circumstances at the outdoor range.** "Shockwave" or "Tannerite" Targets are permitted with written email permission from the club president. If you want to shoot these – on the rifle range – email Sean with the details when and he will book it and provide any conditions. Shooting Tannerite/Shockwave without previous permission will be grounds for expulsion from the club. **"Firebird" targets** – usually available at Canadian Tire are also prohibited on any of AMA's ranges.

**AMA Practice Nights - IPSC shooters.** AMA IPSC practice sessions will move to outside and remain on Wednesday nights whenever the Covid stuff finishes up. This will be for the entire summer. If it is pouring rain, don't expect the gate to be open, but if it's just misting, we'll be there with the gate open. The indoor range will still be available to IPSC Shooters on Wednesday nights & Sunday afternoons as well.

**Outdoor Range Ranges 5-7 remain off limits to anyone that is not currently participating in a recognized action shooting discipline.** Exceptions are available from the Executive in writing.

**RO Hours:** The times presented for shooting on Tuesdays and Saturdays are when the RO is on duty, if shooters are present. If the RO has no shooters within one hour of closing time; he may shut down and go home.

## The Marksmen

**Ranges are not parking lots - PARKING** is only permitted at the outdoor range in the parking lots, with a couple of small exceptions. (See Standing Orders) Vehicles parked elsewhere will be pelted with ricochets, mud, rocks and probably towed downrange to be used as targets.

### How to use a Target Stand for the Outdoor facility.

The proper way to use a stand is to take a piece of cardboard and staple it across both uprights on the stand. Then attach a target to the cardboard. Do not attach a target so that your shots will penetrate the target and the upright of the target stand.

**Parking at Outdoor range** - When you park; **do not block any other vehicle and do not block the access roads** to the rifle range or the back pistol ranges. If there is no parking remaining close to the rifle range, you'll have to park in the pistol range parking lot and walk. Please be considerate to your fellow range users so we don't have to deal with this this summer.

### Outdoor Range Schedule.

**IPSC** - May 31, June 14, July 19, Sept 6 & 13, Oct 11  
(Ranges 1-7 in Use)

**IPSC Provincial Championships – August 15/16** Ranges 1-7 in Use. (General Shooting Indoors August 15)

**This schedule may change – we will email out if any changes are necessary.**

**Ticks at the outdoor range.** Like every year, there will again be ticks at the outdoor range. Make sure that you use insect repellent with lots of DEET in it and check yourself thoroughly when you return from the range to ensure none have hitched a ride on you.

**Please Help Us Clean Up** - Just a reminder that when you use the facilities, please throw your discarded brass, old targets, **coffee cups**, patch backers, etc. in the garbage cans and not on the range surface. When you use the indoor range, sweep up after yourself and when you're outdoors remember to **take down your old target**. It's no use to anyone after the rain gets on it the next day.

**Woods Travel Ban:** If we have a dry summer, the province might institute a woods travel ban. The outdoor range is exempt from this and remains open during the ban. Just be sure to be careful when it comes to any fires, i.e. smoking, etc.

## Atlantic Marksmen Association

### Contact Us

The editor, publisher, folder, packer and mailer of this newsletter is the president of the club; Sean Hansen. Sean can be reached at work at 455-5483 or via email at [atlanticmarksmen@gmail.com](mailto:atlanticmarksmen@gmail.com)  
Our mailing address is AMA, PO Box 181 Dartmouth Main, Dartmouth, NS B2Y 3Y3

Don't forget our Website [www.atlanticmarksmen.ca](http://www.atlanticmarksmen.ca)

### Don't forget at the Outdoor Range:

- **Failure to sign in at the facility before you fire your first shot will result in you being sent off the property for the day.**
- **Through May, please drive slowly and don't cause pot holes.**
- ***GARBAGE: Take care of it yourself!!! At the outdoor range, there is a dumpster in the parking lot. If you fill a garbage can, take the bag and put next to the dumpster and we'll put it in***
- ***Have your current membership card with you. No card = no proof of membership and ejection from the facilities.***
- ***Park properly! Don't block others in and keep your vehicles in safe locations.***
- **Steel Shooting at the Outdoor Range** Steel plates or poppers shot on Ranges 2&3 cause splatter to land on ranges 5&6. Therefore steel on range 2,3&4 must be shielded. Steel shot on Range 1 causes splatter to land on range 2 & 4, so unless the steel is at the end of the range - it, too must be shielded.

**DO NOT shoot steel that does not belong to you.**

### Section Chairs & Executive

Sean Hansen – Pres. 455-5483  
[sales@freedomventures.ca](mailto:sales@freedomventures.ca)

James Smith – Vice Pres. [Jim@division8.co](mailto:Jim@division8.co)

Graham Fortune – Treasurer 497-1143  
[gbfort@bellaliant.net](mailto:gbfort@bellaliant.net)

Anees Obeid – Secretary 830-6969 [anees@eastlink.ca](mailto:anees@eastlink.ca)

Brad Browne – Section Chair; Long Arms  
221-5646 [coffee@ns.sympatico.ca](mailto:coffee@ns.sympatico.ca)

Andrew Brace – Section Chair; Handgun  
435-7510 [andrewbrace6@hotmail.com](mailto:andrewbrace6@hotmail.com)

**AMA Shooting Schedule  
May 1, 2020 to Oct 3, 2020**

<b>Monday Evenings</b>	<b>Air Pistol and Rifle Indoors. Begin at 6:30 PM</b>
<b>Tuesday Evenings</b>	<b>General Handgun. All members are welcome. Begin at 6:30PM at the Indoor Range.</b>
<b>Wednesday Evenings</b>	<b>IPSC Shooting. Black Badge Holders, beginning at 5:30 PM Indoors &amp; Shooting is also on non-rainy nights at the outdoor range, beginning at 5:30 PM.</b>
<b>Thursday Evenings</b>	<b>ISU / ISSF Style Shooting in the indoor range. Begin at 6:30.</b>
<b>Saturday Afternoon</b>	<b>General shooting. All members are welcome. Range 1. Begin at 1:00 PM <u>at the outdoor range.</u> <i>NOTE: RO may pack up and leave if no one is left shooting at 3.</i></b>
	<b>Shotgun Shooting. All members welcome (bring your own clays) Held from the shotgun shelter in the outdoor range. Begin at 1:00 PM.</b>
<b>Sunday Morning</b>	<b>Rifle Shooting on Outdoor Rifle Range. Begins at 10, ends at noon.</b>

The following motions will be tabled at the AGM.

**The Proxy Form will be regarding the following Motions.**

1. Income issues.

**The Board is recommending a junior membership increase from \$30 to \$50 this year.** A Motion will be presented. It has been over two decades since AMA raised its junior member dues.

These Housekeeping Motions will be presented. We have always approved these motions.

2. Motion for AMA to Associate with the Shooting Federation of Nova Scotia.
3. Motion for AMA to Associate with the Shooting Federation of Canada.

**Elections are held every three years; the next one will be in 2022.**

#### General Information

If you do not have your current membership card with you while on AMA premises, you may be asked to leave.

- Refer to AMA Guest Rules for information regarding guests at AMA premises.
- **One person on the range proper MUST be a certified Range Officer.**
- Range Hours are 8:30 AM to 9:30 PM. No shooting outside of those times unless prior approval from the board has been granted.
- The following is prohibited: Steel reactionary targets unless shrouded. (I.e. plates, silhouettes, etc.), Black Powder firearms. Steel core or jacketed ammunition, Incendiary or Explosive Targets, Rifle Caliber Centerfire rifles / carbines, **Pistol Caliber Carbines (i.e. 9mm, 38 Special, 40S&W, 45ACP, 44 Mag, 357 Mag) are specifically permitted.**
- Magnum pistol calibers are permitted with the permission of the Range Officer and Chief Range Officer. Please consider others on the range with regard to concussion and noise.
- Jacketed ammunition is permitted and encouraged (less smoke)
- No shooting within 3 meters of the backstop.
- No Eating, Drinking or Smoking or Prone shooting on the ranges.
- Sweep the range floor with dust bane and throw it in the garbage when you are done shooting.

#### Before any Shooting

- All guests must be signed into the logbook. Both their host member and Guest must have their names legible.
- Inform the Range Officer you will be shooting before doing anything else. He will instruct you as to when and where you can un-box your firearm and shoot.

#### During Shooting

- Eye and Ear protection are mandatory for all shooters and spectators from the minute they walk into the range until they leave
- No Range may be used without a Range Officer present.

#### Standard (General Shooting) Range Commands:

**Eyes and Ears!**

- Ensure you are using your hearing and eye protection.

**Approach The Line.**

- Move forward and un-box your firearm and /or handle it to prepare for shooting.

**On your own Time, Fire.**

- Shoot at your target, reload and continue if you have to.

**Cease Fire!**

- Stop Shooting, unload your gun, leave it open on the table and step back from the firing line.

**The Line is Clear.**

- Go around the tables and approach your targets. Do not approach the tables from behind the firing line again until told to do so.

#### After Shooting

- Take down your targets and cardboard backers and put them away. Tear up worn-out backers and put them in the garbage.
- Pick up your spent cartridges. This includes rim fire. If you don't want them, dispose of them in the brass bins.
- Turn off the ventilation, turn out the lights and lock the door (both locks) behind you.

#### Emergencies

In the Event of an Emergency, call 911. The range Address is 6 Clements St. Dartmouth.

- **Violation of these standing orders will incur a review of the member's actions by the board and could result in suspension of privileges and / or expulsion from the club.**

## Atlantic Marksmen Association - Standing Orders for the Ralph Dunn Range

### General Information

- If you do not have your current membership card with you while on AMA premises, you will be asked to leave.
- Guests are entitled to shoot with a member; but must join after the second visit to continue using the club facilities. **No more than 3 guests per member** are permitted on the property.
- **One person in each range bay MUST be a certified Range Officer.**
- Range Hours are 10:00 AM to Dusk. No shooting outside of those times unless prior approval from the board has been granted.
- Smoking is only permitted in the parking lot areas. This includes vaping and inhalers.
- The Chief Range Officer (CRO) is the range officer who first opened the gate to the facility. He must designate a new CRO (who must be a range officer) when he leaves or he will have to evict everyone and lock the gate. Anyone who arrives after the CRO who wants to open a new range bay must let the CRO know he is going to do so.
- Parking is to the left and right of the range rules sign. Only vehicles authorized by the CRO & those vehicles with handicapped passes may proceed to the range surfaces.
- Steel may only be shot by pistol calibers and never on ranges 1, 2 or 3 unless shrouded.
- Explosive targets (tannerite, shockwave, etc.) may only be used with written permission of the club president. **Firebird explosive targets may NOT be used**
- Balloons as targets are prohibited.
- Center fire rifle ammunition is prohibited from shooting steel unless the steel is personally owned or the rifle range flash targets are used.

### Before any Shooting

- All members and guests must sign in the logbook in the sign-in shack.
- Red Flags must be raised at the entrance gate, at the sign in shack and at each range bay that is in use.

### During Shooting

- Eye protection is mandatory for all shooters and spectators on active ranges. Eye protection must be worn when a red flag is raised on a range bay.

### Standard (General Shooting) Range Commands:

- |                                |                                                                                                                                     |
|--------------------------------|-------------------------------------------------------------------------------------------------------------------------------------|
| <b>Eyes and Ears!</b>          | - Ensure you are using your hearing and eye protection.                                                                             |
| <b>Approach The Line.</b>      | - Move forward and un-box your firearm and /or handle it to prepare for shooting.                                                   |
| <b>On your own Time, Fire.</b> | - Shoot at your target, reload and continue if you have to.                                                                         |
| <b>Cease Fire!</b>             | - Stop Shooting, unload your gun, leave it open on the table and step back from the firing line.                                    |
| <b>The Line is Clear.</b>      | - Go around the tables and approach your targets. Do not approach the tables from behind the firing line again until told to do so. |

### Range Specific Rules

#### Rifle Range

- All shooting will be from under the covered firing point unless a board-approved action shooting event is taking place.
- All targets will be placed in front of a berm such that the bullet will travel through the target at strike the berm. There are berms at 100yds, 190yds and 280 yds.
- Shooters must check to ensure that the shotgun range is not in use when proceeding downrange to check targets. It is best to go behind the shotgun shack when proceeding downrange.

#### Shotgun Range

- Shotgun shooting from the shotgun shelter with the throwers will only take place under the supervision of a designated "Shotgun" Range Officer.
- No bigger than 7.5 shot size may be used at range 8 (the shotgun shelter with skeet throwers)
- Shotguns will be stored in racks, unloaded, except when actually in use on firing point and will not be loaded until the shooter is given the command to load.
- Shooters are limited to 10 rounds per turn and must provide own clays.
- Shooters will not advance forward past the firing positions (into the line of fire from the rifle range)

### After Shooting

- Take down your targets and cardboard backers and put them away. Tear up worn-out backers and put them in the garbage.
- Pick up your spent cartridges. This includes rim fire, steel cases and shotgun hulls. If you don't want them, dispose of them in the brass bins or garbage.
- Sign out in the logbook.

### Emergencies

In the Event of an Emergency, call 911. The Range Address is 2965 Old Guysborough Rd.

**Violation of these standing orders will incur a review of the member's actions by the board and will likely result in suspension of privileges and / or expulsion from the club.**

**RO Schedule May 12 – September 5, 2020**

*(Becomes active as soon as the COVID Restrictions are dropped)*

<b>OUTDOORS SATURDAYS</b>		
Tues, May 12/20	Scott Vigneault	
Sat, May 16/20	Heather Taylor	
Tues, May 19/20	James Stephens	
Sat, May 23/20	Tim Furey	
Tues, May 26/20	Keith Knight	
Sat, May 30/20	Graham Curren	
Tues, June 02/20	Wayne Gillis	
Sat, June 06/20	Denis Fortin	
Tues, June 09/20	Robert Jeffery	
Sat, June 13/20	Todd Harnish	
Tues, June 16/20	Wayne Doucette	
Sat, June 20/20	David Bardsley	
Tues, June 23/20	John Parkin	
Sat, June 27/20	Douglas Reid	
Tues, June 30/20	Randall Nelson	
Sat, July 04/20	Tony Tufts	
Tues, July 07/20	Fred Walsh	
Sat, July 11/20	Chris Turner	

Tues, July 14/20	James Stephens	
Sat, July 18/20	Bob Cooke	
Tues, July 21/20	Glen Gorveatte	
Sat, July 25/20	Henri Gauci	
Tues, July 28/20	Gary Leights	
Sat, Aug 01/20	Peter Henderson	
Tues, Aug 04/20	Mark Banford	
Sat, Aug 08/20	Daryl Boutilier	
Tues, Aug 11/20	Ross Jefferson	
<b>AUGUST 15<sup>th</sup> is INDOORS</b>		
Sat, Aug 15/20	Don Banton	
<b>BACK TO OUTDOOR SCHEDULE SATURDAYS</b>		
Tues, Aug 18/20	John West	
Sat, Aug 22/20	Don Roth	
Tues, Aug 25/20	Simon Field	
Sat, Aug 29/20	Lot Cossar	
Tues, Sept 01/20	John Francis Rooney	
Sat, Sept 05/20	Keith Knight	

**YOU ARE RESPONSIBLE TO OPEN THE RANGE  
AT THESE DESIGNATED DATES  
IF YOU CANNOT OPEN THE RANGE, IT IS YOUR  
RESPONSIBILY TO ENSURE YOUR  
REPLACEMENT DOES.**

OUTDOOR RANGE PARKING GUIDE & RANGE #s

*Atlantic Marksmen Association  
Ralph Dunn Range*

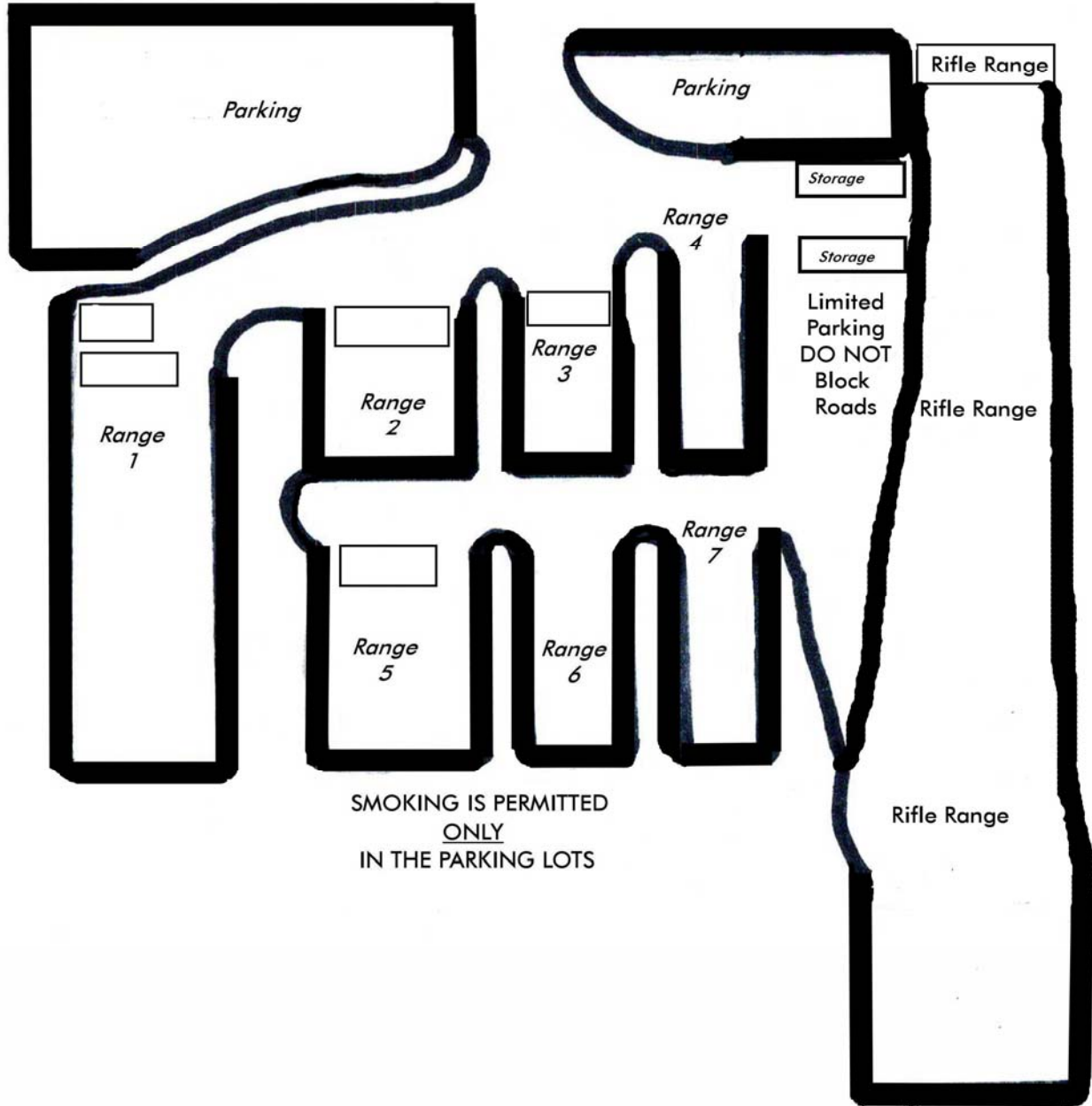

**IF IT DOESN'T SAY YOU CAN PARK THERE,  
DON'T PARK THERE!!!!**

*We won't be responsible to the damage that will occur to improperly parked vehicles.*



**Atlantic Marksmen Association 2020 Proxy**

This proxy will be used to represent the member \_\_\_\_\_ for the Annual General Meeting of the Atlantic Marksmen Association to be held on May 26, 2020 at the Atlantic Marksmen Association club house, 6 Clements St. Dartmouth, NS.

**Place a large check mark (  ) in the box of your choice**

*(The small "x" indicates the AMA Executive recommendation, no check mark indicates member agrees with Executive Recommendation.)*

<b>Motion</b>	<b>Yes</b>	<b>No</b>	<b>Abstain</b>
1     Raise junior membership dues to \$50 from \$30	x		
2     AMA Associate with SFNS for 2020-2021	x		
3     AMA Associate with SFC for 2020-2021	x		

I hereby appoint AMA secretary, Mr. Anees Obeid to register my proxy as above at this Annual General Meeting.

\_\_\_\_\_  
Signature

**Please Check (  ) the above boxes and mail before May 15, 2020.**

**AMA Guest Rules – Applies to Indoor and Outdoor Ranges  
Effective January 7, 2016**

- Members are completely responsible for the actions and conduct of their guests.
- Members are permitted to have a total of **Four** guest visits per membership year. *(I.e. 2 people twice each, 1 person twice and 2 more people once each, 4 separate people once each, etc.)* Additional visit credits may be requested from the Executive and will be issued in special circumstances.
- If a member's guest joins the club, their visits will be removed from the member's guest visit count.
- A guest may attend up to **two** times; but must join before being permitted to return the third time.
- **Guests may not bring personal firearms.** Guests may only shoot member's firearms.
- No more than **Three** guests may accompany a member to the range, with the exception of General Shoots on Tuesdays and Saturdays. At General Shoots; members may only bring one guest with them.
- **When guests are shooting, their host member may not.**
- At General Shoots; Members must share their shooting position on the line with their guest.
- When members bring spectators who do not shoot, these spectators are not considered guests. *(I.e. if a Range Officer brings their spouse to be the second person on the range.)*
- Attendance at official competitions & training sanctioned by AMA's executive & included on the AMA Calendar are not considered guest attendance.